





BAUSTEIN



WOLKE

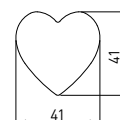
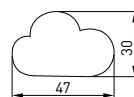
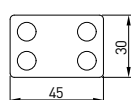

STERN



KNOPF

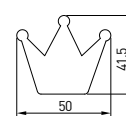
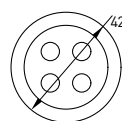
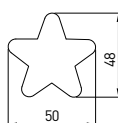

FLAMINGO



HERZ



	grün	blau	rot	grau	gelb	pink	
Baustein	UM-BLOCK-ZL	UM-BLOCK-NB	UM-BLOCK-CZ	-	-	-	Gummi, ZnAl
Wolke	-	UM-CLOUD-NB	-	UM-CLOUD-SZ	-	-	
Stern	-	UM-STAR-NB	-	-	UM-STAR-ZT	UM-STAR-RZ	
Knopf	-	UM-BUTTON-NB	-	UM-BUTTON-SZ	-	-	
Flamingo	-	-	-	UM-FLAMING-SZ	-	UM-FLAMING-RZ	
Herz	-	-	-	-	-	UM-HEART-RZ	
Krone	-	-	-	-	-	UM-CROWN-RZ	
Vögelchen	UM-TWITT-ZL	-	-	UM-TWITT-SZ	-	-	

# Griff UNICORN

Verfügbar ab April

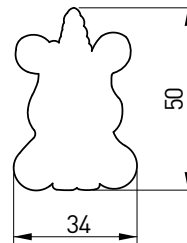



		
Einhorn	UM-UNICORN-RZ	Gummi, ZnAl

# Griff CAPRI

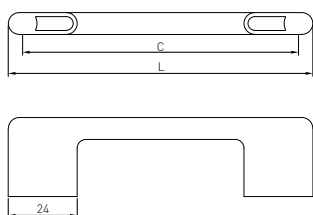
Jetzt verfügbar



C mm	L mm					
		Chrom	Nickel matt	Aluminium	Edelstahlloptik	
96	106	UZ-CAPRI-96-01	UZ-CAPRI-96-02	UZ-CAPRI-96-05	UZ-CAPRI-96-06	ZnAl
128	138	UZ-CAPRI-128-01	UZ-CAPRI-128-02	UZ-CAPRI-128-05	UZ-CAPRI-128-06	
160	170	UZ-CAPRI-160-01	UZ-CAPRI-160-02	UZ-CAPRI-160-05	UZ-CAPRI-160-06	
192	202	UZ-CAPRI-192-01	UZ-CAPRI-192-02	UZ-CAPRI-192-05	UZ-CAPRI-192-06	
256	266	UZ-CAPRI-256-01	UZ-CAPRI-256-02	UZ-CAPRI-256-05	UZ-CAPRI-256-06	
320	330	UZ-CAPRI-320-01	UZ-CAPRI-320-02	UZ-CAPRI-320-05	UZ-CAPRI-320-06	

# Griff FLAVIO

Verfügbar ab April

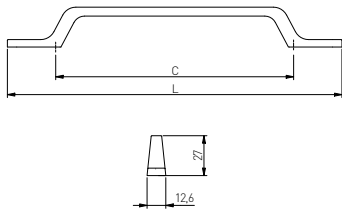

C mm	L mm					
		Chrom	Edelstahloptik	Gold Messing	schwarz matt	
96	161	UZ-FLAVIO-96-01	UZ-FLAVIO-96-06	UZ-FLAVIO-96-16	UZ-FLAVIO-96-20M	ZnAl
128	193	UZ-FLAVIO-128-01	UZ-FLAVIO-128-06	UZ-FLAVIO-128-16	UZ-FLAVIO-128-20M	
160	225	UZ-FLAVIO-160-01	UZ-FLAVIO-160-06	UZ-FLAVIO-160-16	UZ-FLAVIO-160-20M	

# Griff MILANO

Jetzt verfügbar

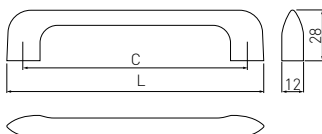

C mm	L mm				
		Chrom	Aluminium	Edelstahloptik	
32	55	GZ-MILAN-32-01	GZ-MILAN-32-01	GZ-MILAN-32-06	ZnAl
128	146	UZ-MILAN-128-01	UZ-MILAN-128-05	UZ-MILAN-128-06	
256	274	UZ-MILAN-256-01	UZ-MILAN-256-05	UZ-MILAN-256-06	



**Griff FLAVIO**

# Griff GO

Jetzt verfügbar

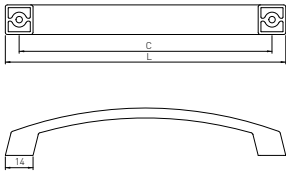

C mm	L mm				
		Chrom	Aluminium	Edelstahloptik	
128	142	UZ-GO-128-01	UZ-GO-128-05	UZ-GO-128-06	ZnAl
160	174	UZ-GO-160-01	UZ-GO-160-05	UZ-GO-160-06	
192	206	UZ-GO-192-01	UZ-GO-192-05	UZ-GO-192-06	
256	270	UZ-GO-256-01	UZ-GO-256-05	UZ-GO-256-06	

# Griff MODENA

Jetzt verfügbar

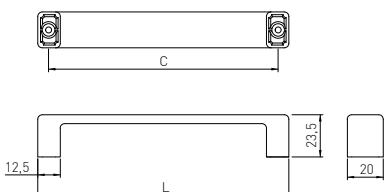

C mm	L mm					
		Chrom	Aluminium	Edelstahloptik	schwarz matt	
128	140	UZ-MODEN-128-01	UZ-MODEN-128-05	UZ-MODEN-128-06	UZ-MODEN-128-20M	ZnAl
160	172	UZ-MODEN-160-01	UZ-MODEN-160-05	UZ-MODEN-160-06	UZ-MODEN-160-20M	
192	204	UZ-MODEN-192-01	UZ-MODEN-192-05	UZ-MODEN-192-06	UZ-MODEN-192-20M	

# Kleiderhaken CORUNA

Verfügbar ab Juni

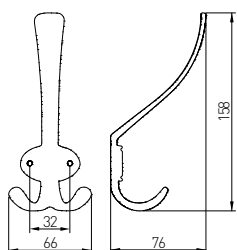



		
WZ-CORUNA-D-04	Altmessing	ZnAl
WZ-CORUNA-D-07	Altsilber	
WZ-CORUNA-D-17	braun	
WZ-CORUNA-D-20M	schwarz matt	

# Kleiderhaken CORUNA

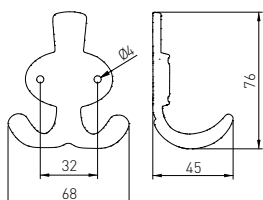
Verfügbar ab Juni



		
WZ-CORUNA-M-04	Altmessing	ZnAl
WZ-CORUNA-M-07	Altsilber	
WZ-CORUNA-M-17	braun	
WZ-CORUNA-M-20M	schwarz matt	

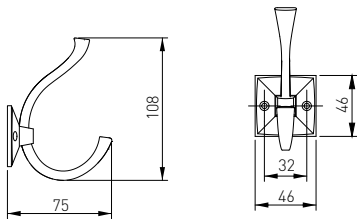

WZ-MADRYT-04	Altmessing	ZnAl
WZ-MADRYT-07	Altsilber	
WZ-MADRYT-15	Altkupfer	
WZ-MADRYT-20M	schwarz matt	

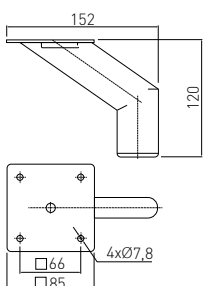

	H mm		
NM-STOMP-100-01*	100	Chrom	Stahl
NM-STOMP-120-20	120	schwarz	
NM-STOMP-120-10*		weiß	
NM-STOMP-130-01*		Chrom	
NM-STOMP-130-20*	130	schwarz	
NM-STOMP-130-06*		Edelstahloptik	
NM-STOMP-150-01*		Chrom	
NM-STOMP-160-01*	160	schwarz	
NM-STOMP-160-20*		Edelstahloptik	
NM-STOMP-160-06*		Edelstahloptik	







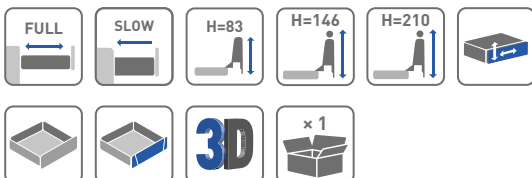
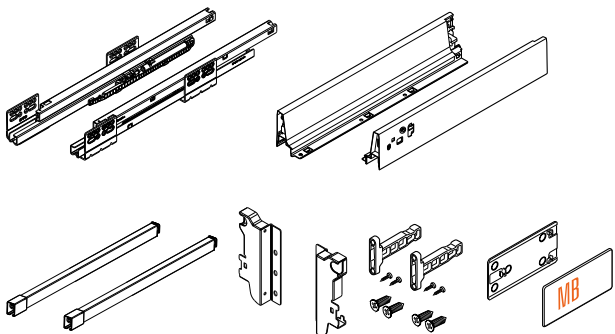
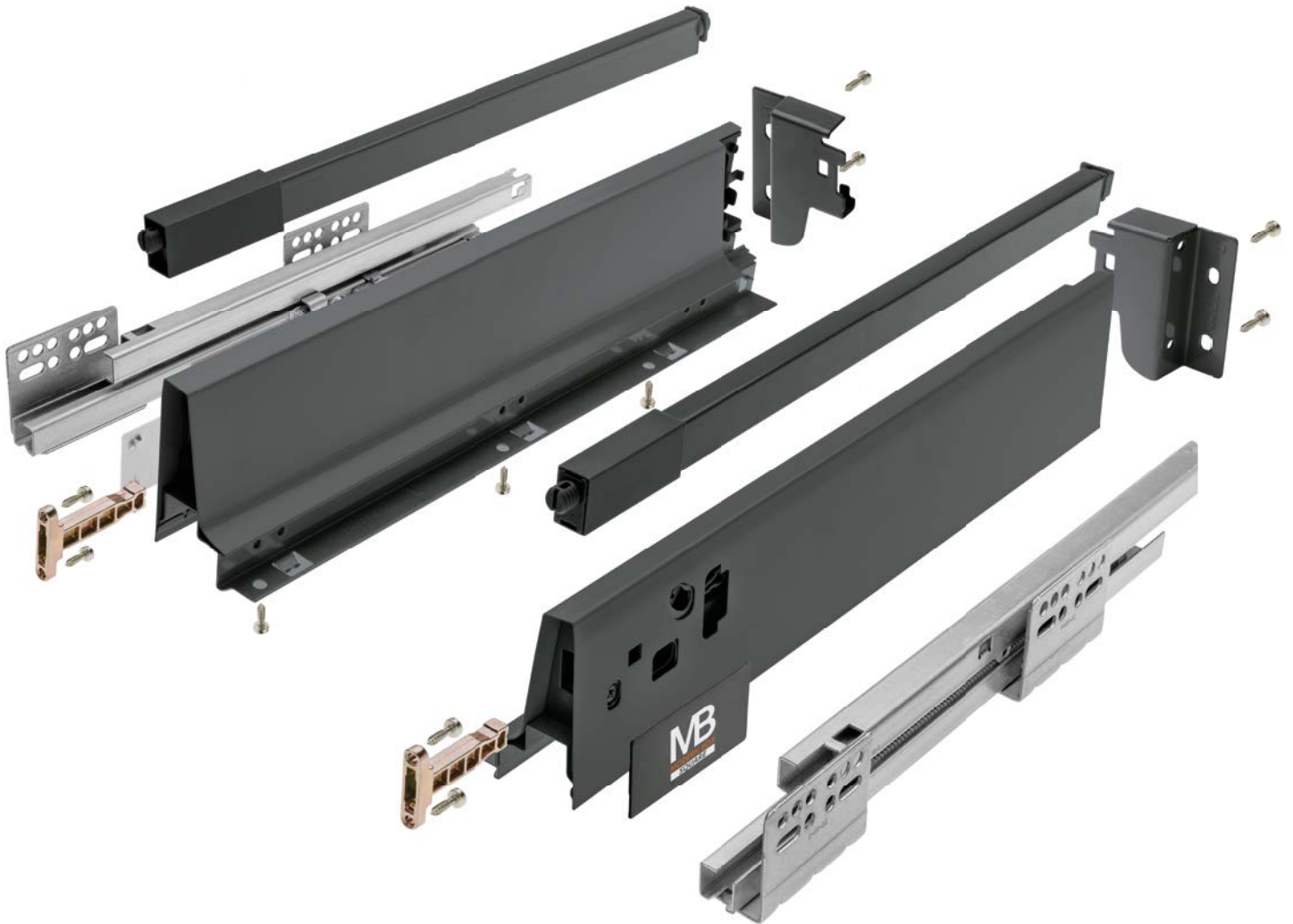

# Modern Box Square

## - Schublade niedrig A, mittelhoch B und hoch C

Verfügbar ab Juni

**NEUE FARBE**







		 L mm	 kg			
PB-KW-KPL250A2		250				
PB-KW-KPL300A2		300				
PB-KW-KPL350A2		350				
PB-KW-KPL400A2		400				
PB-KW-KPL450A2		450				
PB-KW-KPL500A2		500				
PB-KW-KPL550A2		550				
PB-KW-KPL250B2		250				
PB-KW-KPL300B2		300				
PB-KW-KPL350B2		350				
PB-KW-KPL400B2		400	40	anthrazit	lackiert	Stahl
PB-KW-KPL450B2		450				
PB-KW-KPL500B2		500				
PB-KW-KPL550B2		550				
PB-KW-KPL250C2		250				
PB-KW-KPL300C2		300				
PB-KW-KPL350C2		350				
PB-KW-KPL400C2		400				
PB-KW-KPL450C2		450				
PB-KW-KPL500C2		500				
PB-KW-KPL550C2		550				

# Längsreling

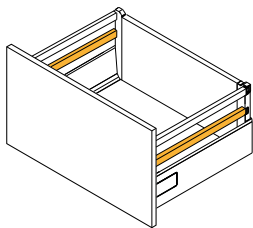
Verfügbar ab Juni

MB Zubehör



	 L mm			
PB-D-RELKW250-60	250	anthrazit	lackiert	Stahl
PB-D-RELKW300-60	300			
PB-D-RELKW350-60	350			
PB-D-RELKW400-60	400			
PB-D-RELKW450-60	450			
PB-D-RELKW500-60	500			
PB-D-RELKW550-60	550			

# Innenfront-Verbinder

Verfügbar ab Juni

MB Zubehör



PB-D-WEWMOCA-KW-60



PB-D-WEWMOCB-KW-60



PB-D-WEWMOCC-KW-60

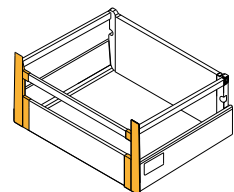
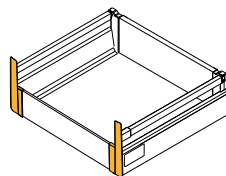
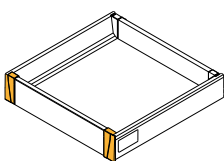

			
PB-D-WEWMOCA-KW-60	Schublade niedrig A	anthrazit	Kunststoff
PB-D-WEWMOCB-KW-60	Schublade mittelhoch B		
PB-D-WEWMOCC-KW-60	Schublade hoch C		

## Innenfront-Paneel

Verfügbar ab Juni

MB Zubehör

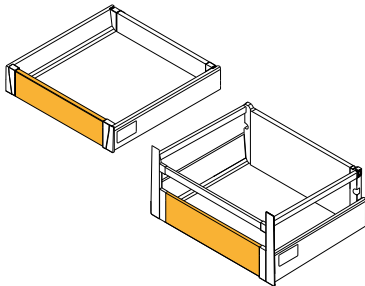

PB-D-PANELWEW-60



1100



anthrazit



Aluminium

## Querreling

Verfügbar ab Juni

MB Zubehör

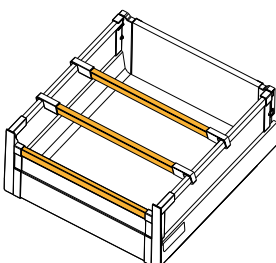

PB-RP-KW1100-60



1100



anthrazit



Stahl

## Verbinder für Querreling

Verfügbar ab Juni

MB Zubehör

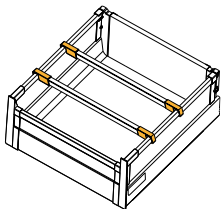

PB-D-ZR-KW-60



1 Set = 2 Stück



anthrazit



Kunststoff

## Querleiste

Verfügbar ab Juni

MB Zubehör

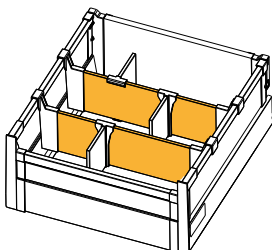

PB-D-LIS1100-KW-60



1100  
mm



anthrazit



Aluminium

## Verbinder für Querleiste

Verfügbar ab Juni

MB Zubehör

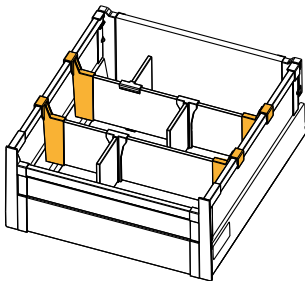

PB-D-CONREL-KW-60



1 Set = 2 Stück



anthrazit



Kunststoff

## Trennung für Querleiste

Verfügbar ab Juni

MB Zubehör

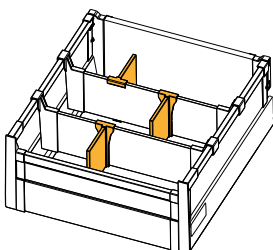

PB-D-PRZEGLP-KW-60



1 Stück



anthrazit



Kunststoff

## Befestigung der Relings an erhöhte Rückwand

Verfügbar ab Juni

MB Zubehör

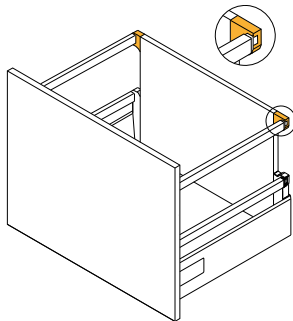

			
PB-D-D2R0-60	1 Set = 2 Stück	anthrazit	Kunststoff

## Rückwandbefestigung

Verfügbar ab Juni

MB Zubehör



PB-D-N2R0-60

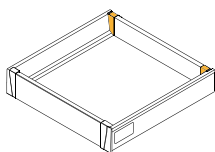

PB-D-S2R0-60

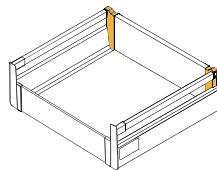

PB-D-W2R0-60

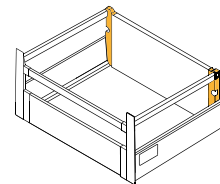

			
PB-D-N2R0-60	1 Set = L+R	anthrazit	Stahl
PB-D-S2R0-60			
PB-D-W2R0-60			

MB Zubehör



PB-D-MHG04-KW-60



1 Stück



anthrazit



Kunststoff



Modern Box Square

## Druckschnäpper, zum Einbohren, kurz

Verfügbar ab April

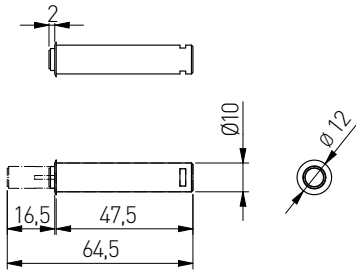
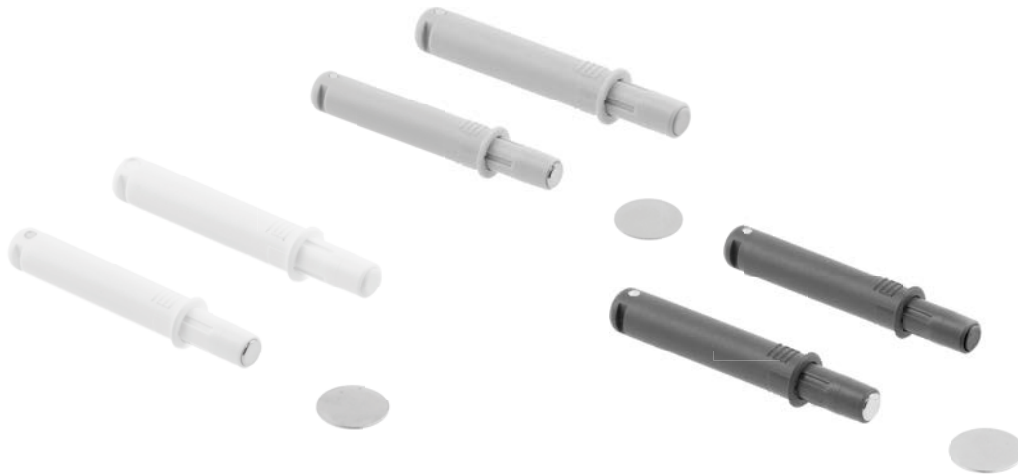

	i		
AM-OWM-KR-MG-10	mit Magnetspitze	weiß	Kunststoff
AM-OWM-KR-GM-10	mit Kautschukspitze		
AM-OWM-KR-MG-30	mit Magnetspitze	grau	
AM-OWM-KR-GM-30	mit Kautschukspitze		
AM-OWM-KR-MG-60	mit Magnetspitze	anthrazit	
AM-OWM-KR-GM-60	mit Kautschukspitze		

## Druckschnäpper, zum Einbohren, lang

Verfügbar ab April

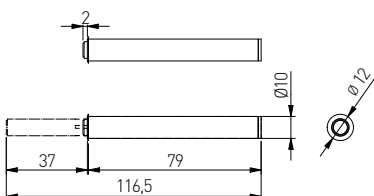
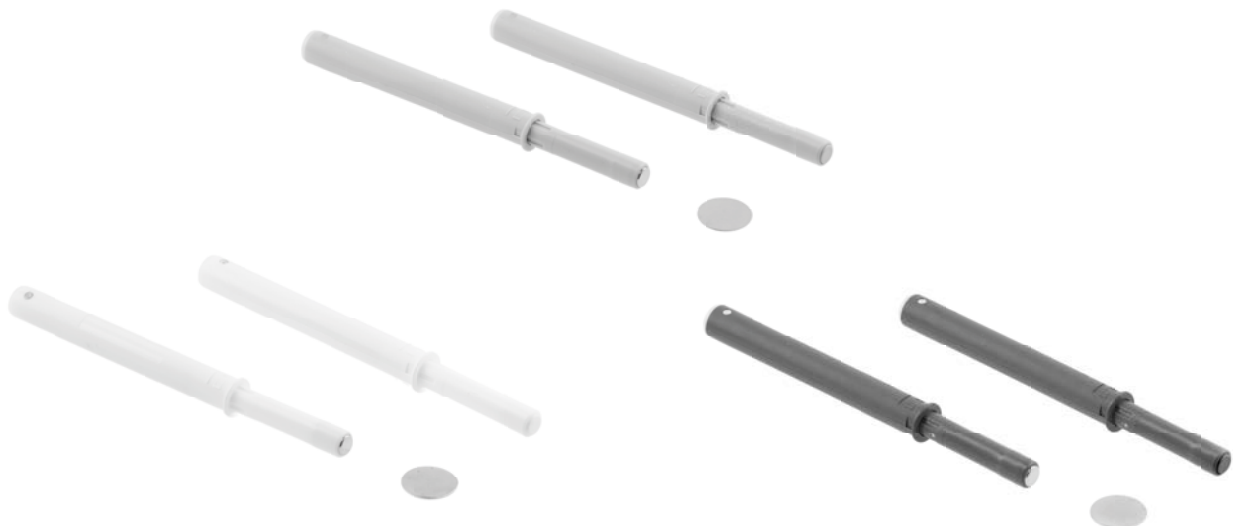

	i		
AM-OWM-DL-MG-10	mit Magnetspitze	weiß	Kunststoff
AM-OWM-DL-GM-10	mit Kautschukspitze		
AM-OWM-DL-MG-30	mit Magnetspitze	grau	
AM-OWM-DL-GM-30	mit Kautschukspitze		
AM-OWM-DL-MG-60	mit Magnetspitze	anthrazit	
AM-OWM-DL-GM-60	mit Kautschukspitze		



## Druckschnäpper, kurz mit Adapter

Verfügbar ab April

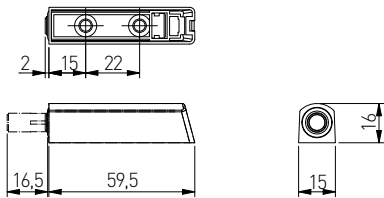
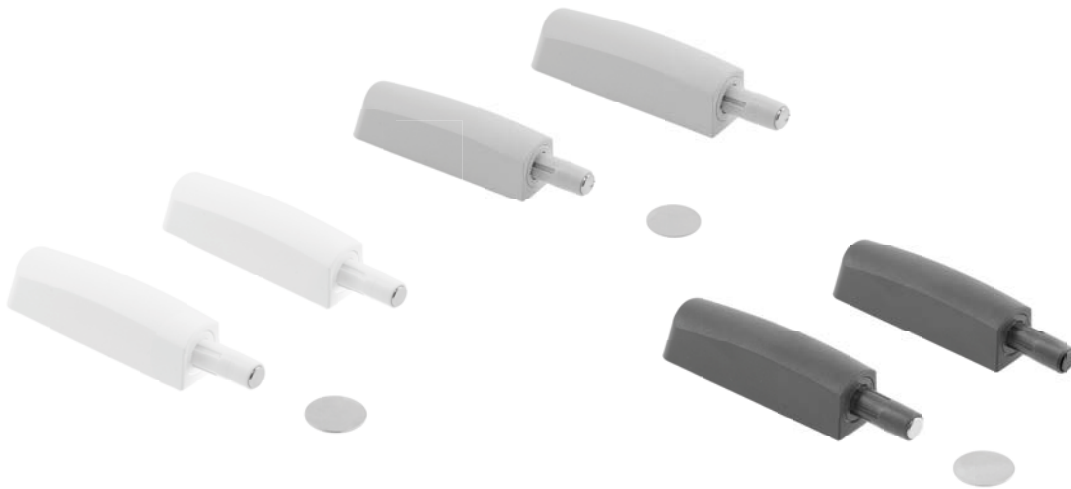

AM-OAM-KR-MG-10	mit Magnetspitze	weiß	Kunststoff	
AM-OAM-KR-GM-10	mit Kautschukspitze			
AM-OAM-KR-MG-30	mit Magnetspitze	grau		
AM-OAM-KR-GM-30	mit Kautschukspitze			
AM-OAM-KR-MG-60	mit Magnetspitze	anthrazit		
AM-OAM-KR-GM-60	mit Kautschukspitze			

## Druckschnäpper, lang mit Adapter

Verfügbar ab April

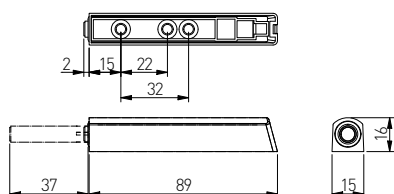
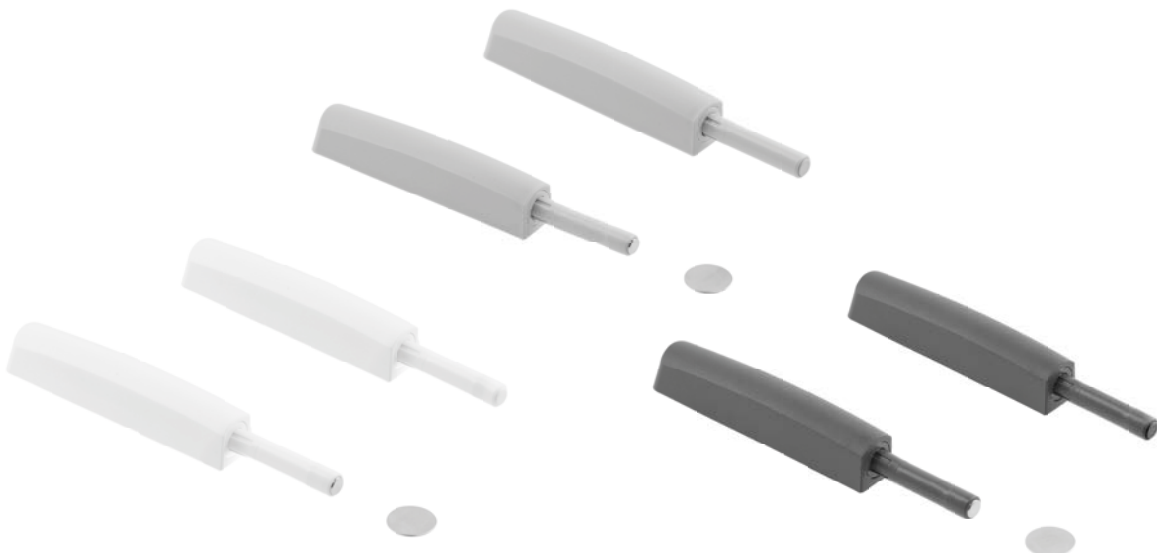

AM-OAM-DL-MG-10	mit Magnetspitze	weiß	Kunststoff	
AM-OAM-DL-GM-10	mit Kautschukspitze			
AM-OAM-DL-MG-30	mit Magnetspitze	grau		
AM-OAM-DL-GM-30	mit Kautschukspitze			
AM-OAM-DL-MG-60	mit Magnetspitze	anthrazit		
AM-OAM-DL-GM-60	mit Kautschukspitze			



Gasdruckfeder mit integriertem Dämpfer

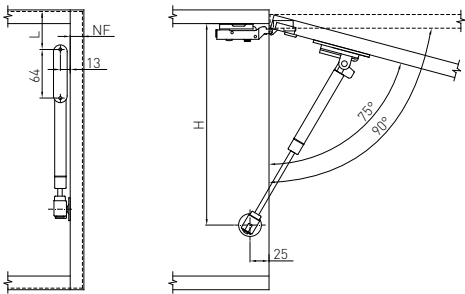

Türöffnungswinkel	H (mm)	L (mm)
75°	265	65
90°	245	50



Modell	Kraft (N)	Farbe	Material
PD-GAMB050-N02	50 N	grau	Stahl, Kunststoff
PD-GAMB060-N02	60 N		
PD-GAMB080-N02	80 N		
PD-GAMB100-N02	100 N		
PD-GAMB120-N02	120 N		
PD-GAMB150-N02	150 N		
PD-GAMB050-N10	50 N	weiß	
PD-GAMB060-N10	60 N		
PD-GAMB080-N10	80 N		
PD-GAMB100-N10	100 N		
PD-GAMB120-N10	120 N		
PD-GAMB150-N10	150 N		
PD-GAMB050-N60	50 N	anthrazit	
PD-GAMB060-N60	60 N		
PD-GAMB080-N60	80 N		
PD-GAMB100-N60	100 N		
PD-GAMB120-N60	120 N		
PD-GAMB150-N60	150 N		

Türöffnungswinkel	Kraft der Gasdruckfeder	Türhöhe (mm)			
		300	400	500	600
75°	50 N	1.6	1.2	1.0	0.8
	60 N	2.0	1.5	1.2	1.0
	80 N	2.7	2.0	1.6	1.4
	100 N	3.4	2.6	2.0	1.7
	120 N	4.1	3.1	2.5	2.0
	150 N	4.7	3.5	2.9	2.4
90°	50 N	1.5	1.1	0.9	0.7
	60 N	1.8	1.3	1.1	0.9
	80 N	2.4	1.8	1.4	1.2
	100 N	3.0	2.2	1.8	1.5
	120 N	3.6	2.7	2.1	1.8
	150 N	4.1	3.2	2.3	2.1

\*Produkt erhältlich auf individuelle Bestellung

# Regalbodenträger DR6

Jetzt verfügbar

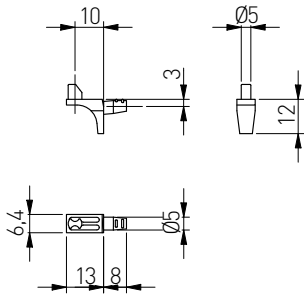

PP-GL-DR6-01	Chrom	ZnAl
PP-GL-DR6-15	nikiel	

# Exzenter FI15X12mm

Jetzt verfügbar

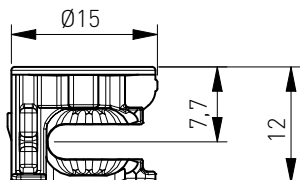

WK-CAM15-12-P	Ø 15 x 12 mm	Chrom	ZnAl

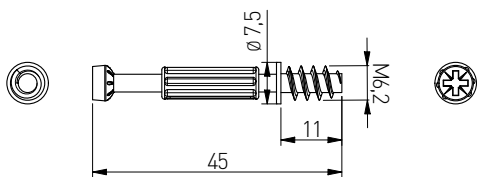

WK-DOW63X45-P	6,3X45	silberfarben, blau	Stahl, Kunststoff

# Verbindergehäuse fi 35 für starke Verbindungen



WK-CAM-FI35



WK-TRZP35-01

WK-TRZP55-01



ZASL-MIM035-10



WK-TCAMS-D-88



WK-MUFAWK-01

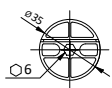

WK-CAM-FI35



WK-TRZP35-01

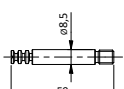

WK-TRZP55-01

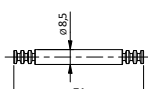

WK-TCAMS-D-88

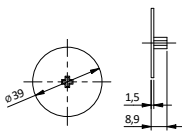

ZASL-MIM035-10

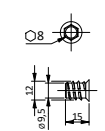

WK-MUFAWK-01

WK-CAM-FI35	Verbindergehäuse Ø 35 für starke Verbindungen	silberfarben	Stahl
WK-MUFAWK-01	Einschraubmuffe mit Kegelflansch M8x15	silberfarben	
WK-TCAMS-D-88	Doppelbolzen für Verbindergehäuse M8 L35		
WK-TRZP35-01	Verbindungsbolzen für Verbindergehäuse M8 L35		
WK-TRZP55-01	Verbindungsbolzen für Verbindergehäuse M8 L55		
ZASL-MIM035-10	Endkappen Ø 35	weiß	Kunststoff

# Drehgestell quadratisch

Jetzt verfügbar

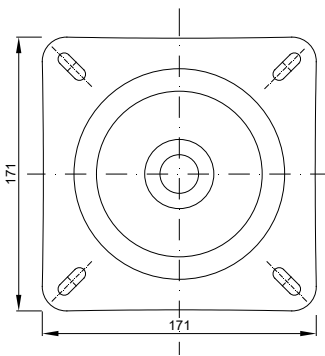

OM-OBK175-20

OM-OBK175-20	100	schwarz	Stahl

# Schnellverbinder

Jetzt verfügbar



SZ-005-00-01-A  
SZ-008-00-01-A

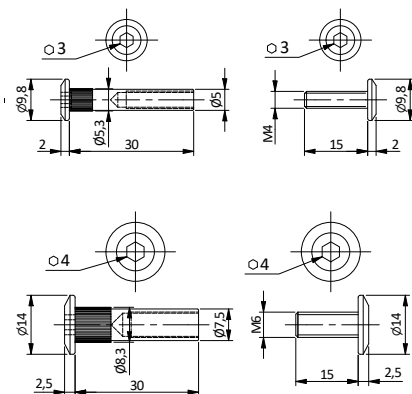

SZ-005-00-01-A	5	Chrom	Stahl
SZ-008-00-01-A	8		

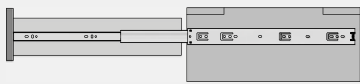
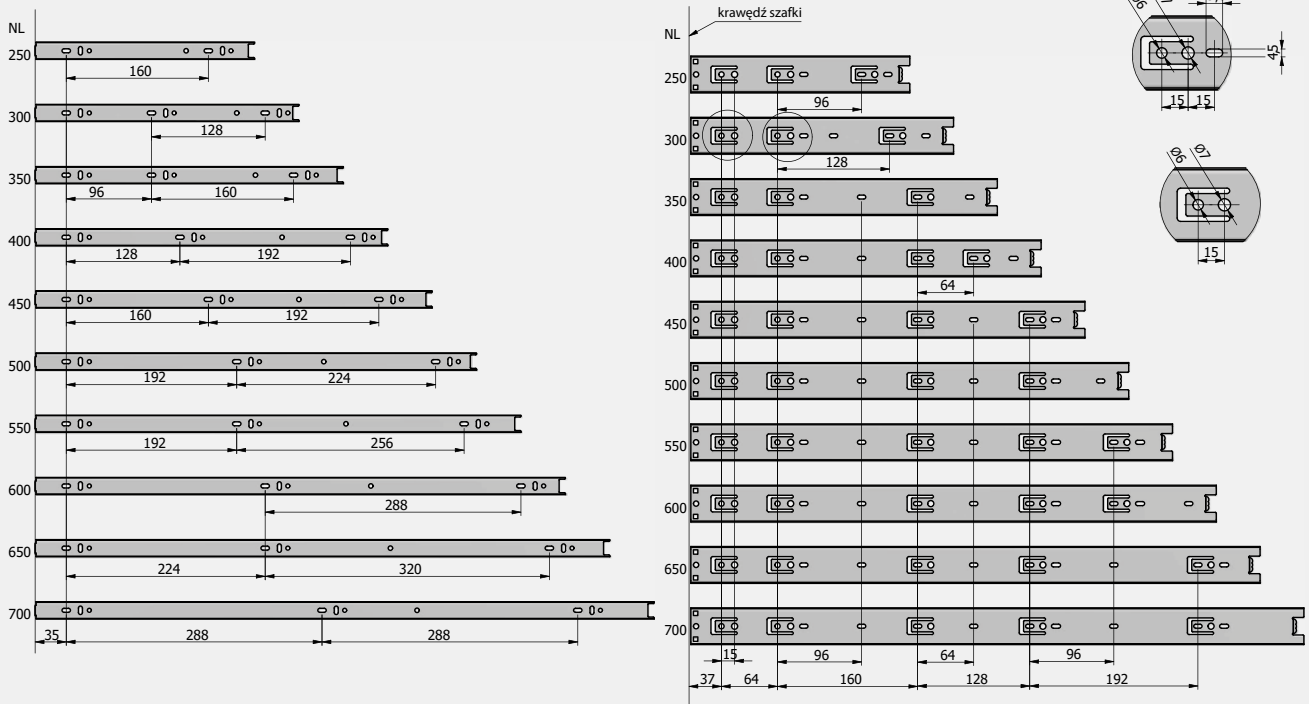

NL = Nennlänge der Führung  
AV = Auszugsverlust

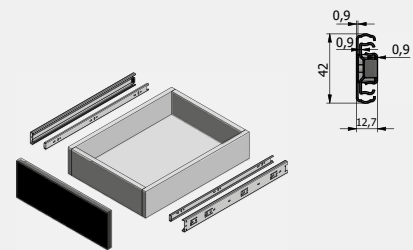

Installationshinweis: Für einwandfreie Funktion der Schublade darf die Breite der Schublade die Nennlänge der Führung nicht überschreiten.

	L mm	AV mm				
PK-0H45250GX2	250	5	Vollauszug	25	verzinkt	Stahl
PK-0H45300GX2	300					
PK-0H45350GX2	350					
PK-0H45400GX2	400					
PK-0H45450GX2	450					
PK-0H45500GX2	500					
PK-0H45550GX2	550					
PK-0H45600GX2	600					
PK-0H45650GX2	650					
PK-0H45700GX2	700					

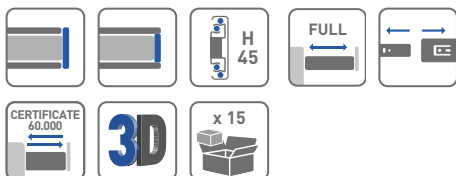

# Schrankaufbauleuchte RADIUS II

Jetzt verfügbar

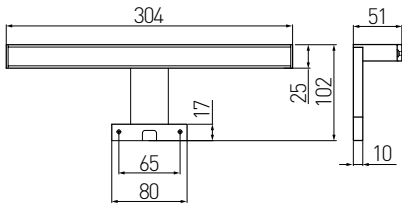

LD-RA60CB-40N	220 lm	3000 K	Chrom	Kunststoff
LD-RA60ZB-40N		6400 K		

# Schreibtisch-Steckdosenleiste COMFORT

Jetzt verfügbar



AE-BPW3S100U-53

AE-BPW3U100U-53

AE-BPW4S100-53

AE-BPW4U100-53

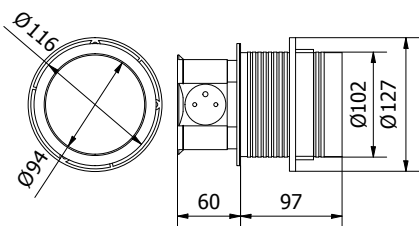

AE-BPW4U100-53	100	french	-	Aluminium	Aluminium, Kunststoff
AE-BPW4S100-53		schuko			
AE-BPW3U100U-53		french	2 x USB 5V 2A		
AE-BPW3S100U-53		schuko			



# Schreibtisch-Steckdosenleiste CHARGER MINI

Jetzt verfügbar



AE-BPW1U1UCH-53



AE-BPW1S1UCH-53

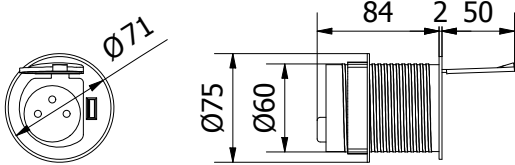

AE-BPW1U1UCH-53	60	french	Aluminium	Aluminium, Kunststoff
AE-BPW1S1UCH-53		schuko		

# Schreibtisch-Steckdosenleiste SLIDE

Jetzt verfügbar



AE-BPW1U1UCH-51



AE-BPW1S1UCH-51

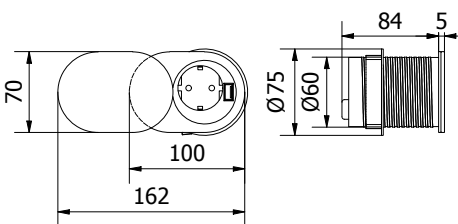

AE-BPW1U1UCH-51	schuko	USB 5V / 2,4A	Aluminium	Kunststoff
AE-BPW1S1UCH-51				



AE-PB02GSHDMI-53



AE-PBC2GUHDMI-53



AE-PBC2GSHDMI-53

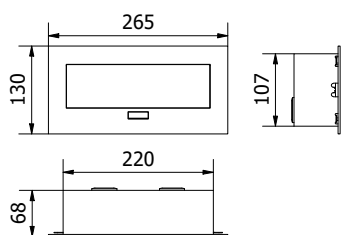

AE-PB02GSHDMI-53	schuko		1 x HDMI, 1 x USB, 1 x RJ45	Aluminium	Aluminium, Stahl
AE-PBC2GUHDMI-53	french		1 x HDMI		
AE-PBC2GSHDMI-53	schuko				



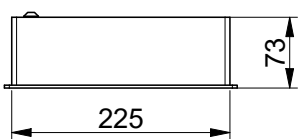
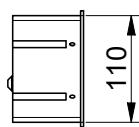
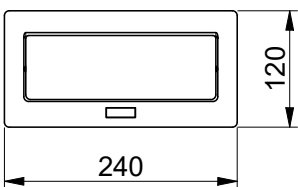

AE-PBSC3GS-10	3 x schuko	-	-	Aluminium Aluminium алюминий	Aluminium, Kunststoff Aluminium
AE-PBSC3GS-20					
AE-PBSC3GS-53					
AE-PBSC3GU-10	3 x french	-	-	Aluminium Aluminium алюминий	Aluminium, Kunststoff Aluminium
AE-PBSC3GU-20					
AE-PBSC3GU-53					
AE-PBSUC2GS-10	2 x schuko	2 x USB	-	Aluminium Aluminium алюминий	Aluminium, Kunststoff Aluminium
AE-PBSUC2GS-20					
AE-PBSUC2GS-53					
AE-PBSUC2GU-10	2 x french	-	-	Aluminium Aluminium алюминий	Aluminium, Kunststoff Aluminium
AE-PBSUC2GU-20					
AE-PBSUC2GU-53					

# LED PRO-Transformator

Jetzt verfügbar

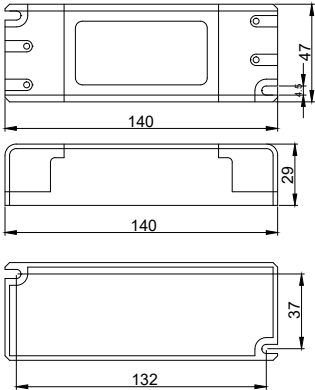



		
LD-ZASPRO33W-30	33 W	Kunststoff

# 1-Zonen Controller MONO

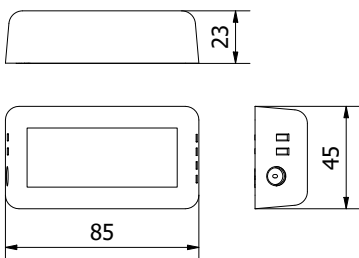
Verfügbar ab April





		
LD-KONML-MONO	RGB	Kunststoff

# 4-Zonen Controller RGBW

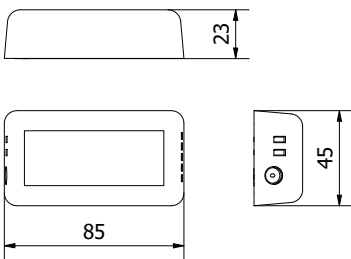
Verfügbar ab April





		
LD-KONML-RGBW	RGB	Kunststoff

# WiFi-Controller DC5V 500mA

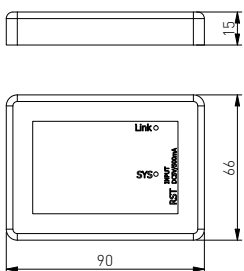
Verfügbar ab April



		
LD-KONML-WIFI	RGB	Kunststoff

## 4-Zonen Fernbedienung MONO

Verfügbar ab April

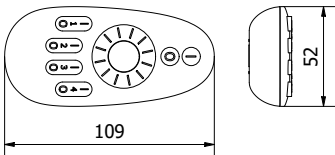

LD-KONML-MONO-PIL



Kunststoff

## 4-Zonen Fernbedienung RGBW

Verfügbar ab April

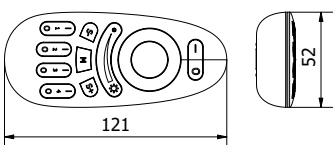

LD-KONML-RGBW-PIL



RGB



Kunststoff

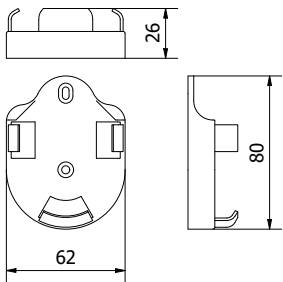

		
LD-KONML-AD	weiß	Kunststoff

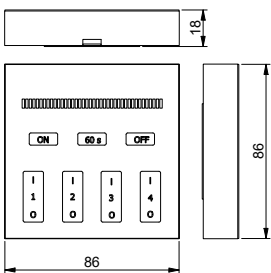

	
LD-KONML-MONO-PAN	Kunststoff

# 4-Zonen Berührungspanel, batteriebetrieben RGBW

Verfügbar ab April

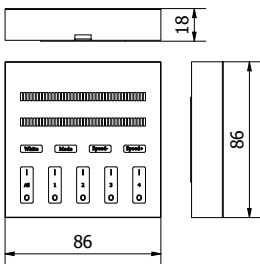
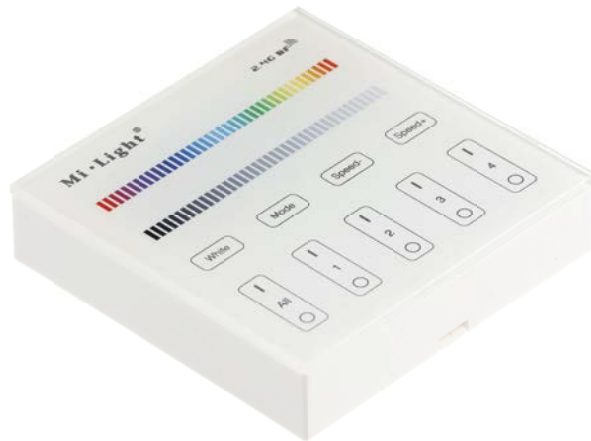

LD-KONML-WRGB-PAN	RGB	Kunststoff

# LED-Streifen FLASH

Verfügbar ab April

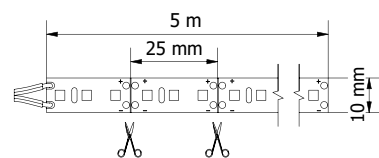
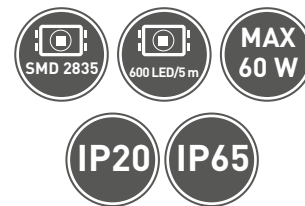

LD-2835-600-20-ZB	12 VDC 60 W	1600 lm/m		20	120°	5	10	120/m	2,5
LD-2835-600-20-NE4									
LD-2835-600-20-CB									
LD-2835-600-65-ZB		1350 lm/m		65					
LD-2835-600-65-CB									



# LED-Streifen FLASH

Verfügbar ab April

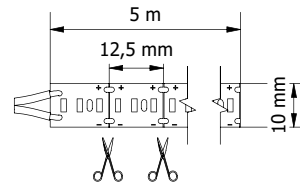
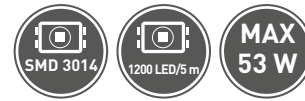

Code	Voltage	Power	Beam Angle	Color	IP	Length	Width	LED Density	Pitch
LD-3014-1200-20-ZB	12 VDC	53 W	1300 lm/m	6500 K	20	120°	5	10	240/m
LD-3014-1200-20-NE4				4000 K					
LD-3014-1200-20-CB				3200 K					

# LED-Streifen FLASH

Verfügbar ab April

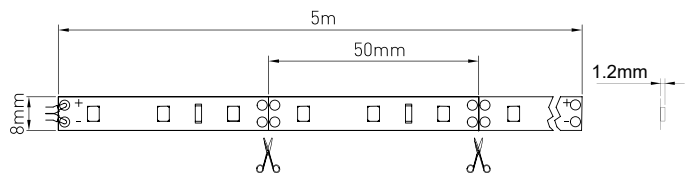
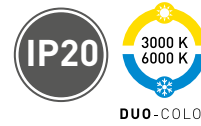
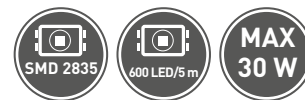

Das Panel arbeitet mit dem Schalter AE-WLKON-20 zusammen.



Code	Voltage	Power	Beam Angle	Color	IP	Length	Width	LED Density	Pitch
LD-2835-60-60-20-CCT	12 VDC	30 W	700 lm/m	3200 K 6500 K	20	120°	5	10	120/m

# LED-Streifen FLASH

Verfügbar ab April

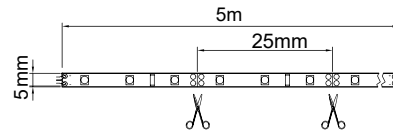
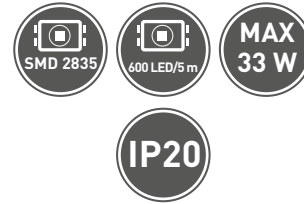

	max			IP		L m	mm		cm
LD-2835-600-5MM-20-ZB	12 VDC 33 W	750 lm/m	● 6500 K	20	120°	5	5	120/m	2,5
LD-2835-600-5MM-20-NE4			● 4000 K						
LD-2835-600-5MM-20-CB			● 3200 K						

# LED-Streifen FLASH

Verfügbar ab Mai

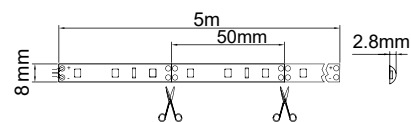
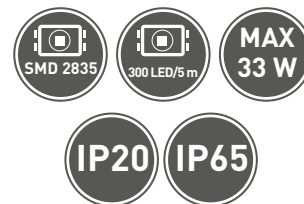

	max			IP		L m	mm		cm
LD-2835-300-20-ZBN	12 VDC 33 W	850 lm/m	● 6500 K	20	120°	5	8	60/m	5
LD-2835-300-20-NE4N			● 4000 K						
LD-2835-300-20-CBN			● 3200 K						
LD-2835-300-65-ZBN		● 6500 K	65						
LD-2835-300-65-NE4N		● 4000 K							
LD-2835-300-65-CBN		● 3200 K							



## Verbinder XC11 für LED-Streifen SLIM

Verfügbar ab Mai

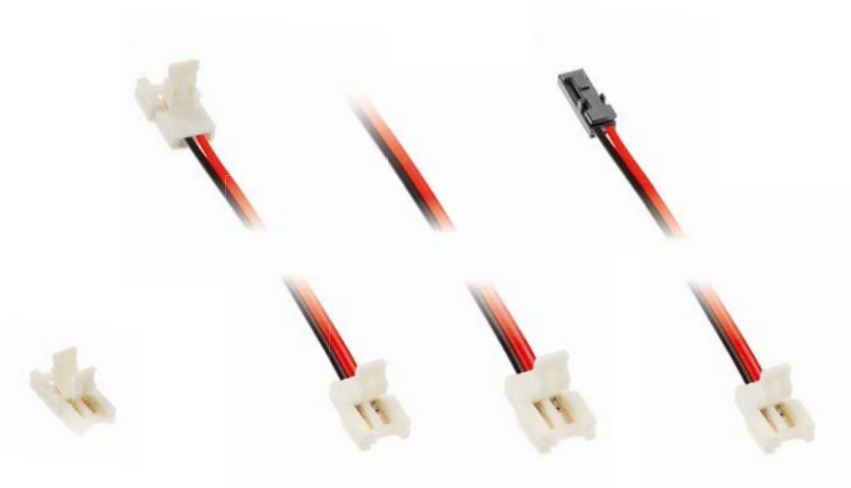

Die Verbinder sind kompatibel mit:

- Glax Profil mit Radiator,
- Glax Einlassprofil, hoch,
- Glax Aufbauprofil mini, hoch,
- Glax Rund-/Stangenprofil

LD-ZTLS8MM-02N

LD-ZTKS8MM-02N

LD-ZTLS82M-2N

LD-ZTLS8MMAMP-02N

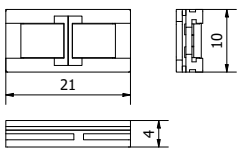

LD-ZTLS8MM-02N

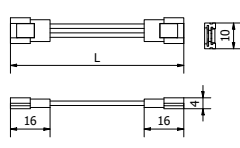

LD-ZTKS8MM-02N

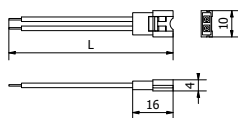

LD-ZTLS82M-2N

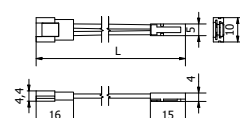

LD-ZTLS8MMAMP-02N



	i	⊞
LD-ZTLS8MM-02N	8 mm	Kunststoff
LD-ZTKS8MM-02N		
LD-ZTLS82M-2N		
LD-ZTLS8MMAMP-02N		

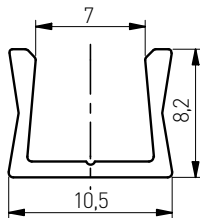
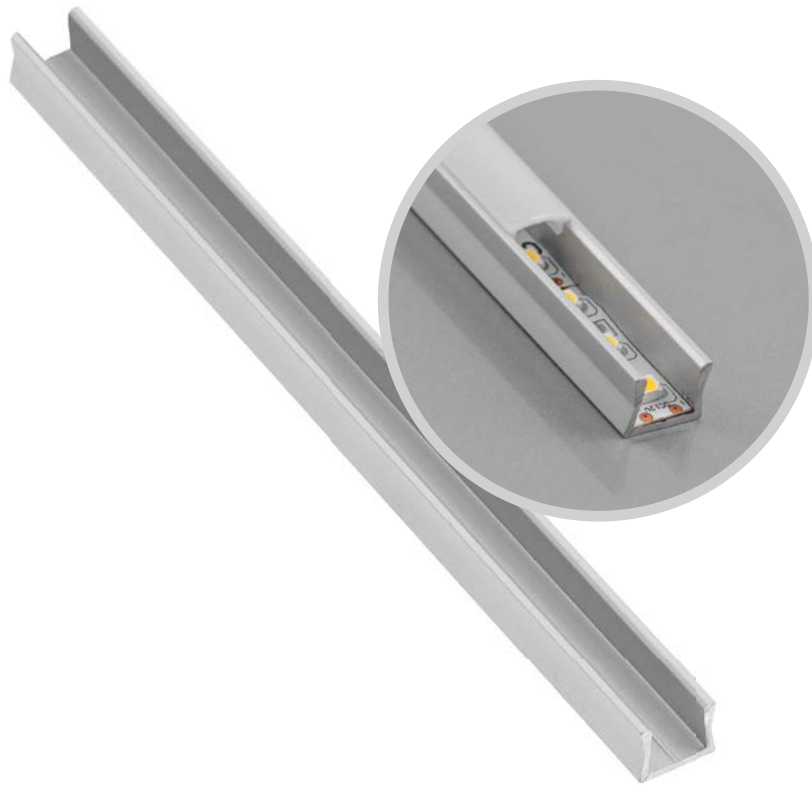

Schmale Lichtlinie. Keine Lichtpunkte bei Verwendung eines speziellen LED-Streifens mit einer Breite von 5 mm.

PA-GLAXMICNK-AL	2	Profil	silberfarben	Aluminium
PA-GLAXMICNK3M-AL	3			
PA-OSMLGLAXMIC-00	2	Mikroabdeckung	milchig	Kunststoff
PA-OSMLGLAXMIC3M-00	3			
PA-ZASGLAXMICNK-00	-	Endkappen	grau	

Abdeckungen



PA-OSMLGLAXMIC-00

Endkappen



PA-ZASGLAXMICNK-00

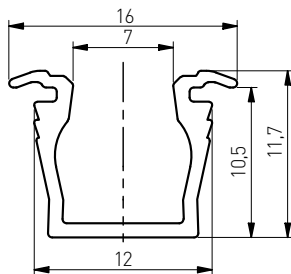
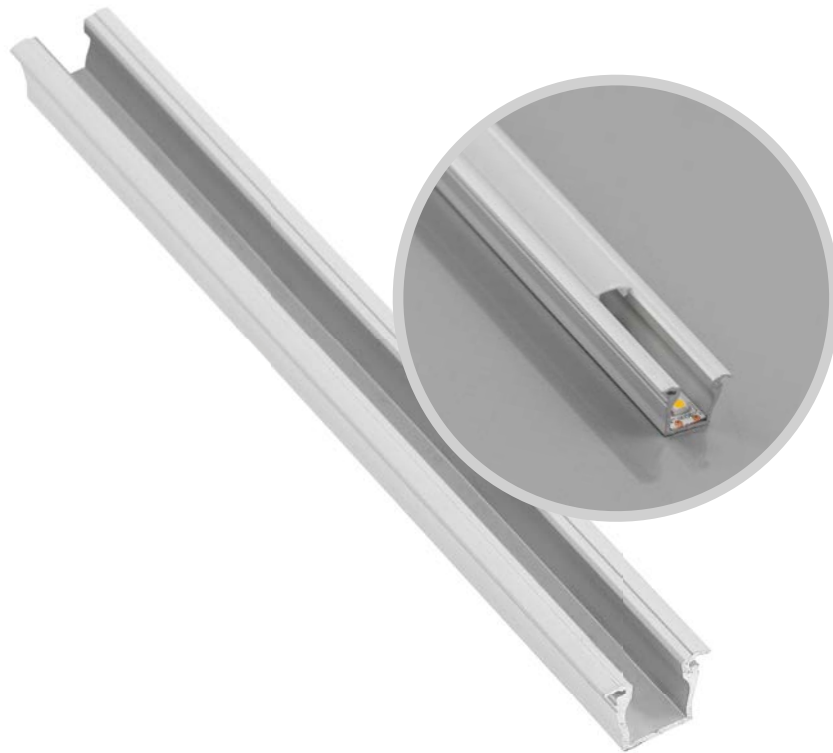

Schmale Lichtlinie. Keine Lichtpunkte bei Verwendung eines speziellen LED-Streifens mit einer Breite von 5 mm.

PA-GLAXMIC-AL	2	Profil	silberfarben	Aluminium	
PA-GLAXMIC3M-AL	3				
PA-OSMLGLAXMIC-00	2	Mikroabdeckung	milchig	Kunststoff	
PA-OSMLGLAXMIC3M-00	3				
PA-ZASGLAXMIC-00	-	Endkappen	grau		

Abdeckungen



PA-OSMLGLAXMIC-00

Endkappen



PA-ZASGLAXMIC-00



**MAX**  
30 W/m

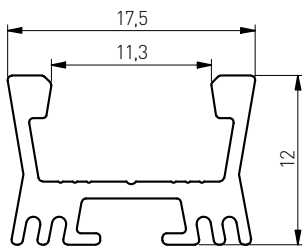

Spezielle Linse, die den Abstrahlwinkel auf 60° verengt. Möglichkeit zum Aufhängen der Leuchte mit Seilen.

PA-GLAXRAD-AL	2	Profil	silberfarben	Aluminium
PA-OSMLGLAXSO-00	2	Linienabdeckung	transparent	Kunststoff
PA-OSMLGLAX-00	2	Abdeckung	milchig	
PA-OSTRGLAX-00			transparent	
PA-ZASGLAXRAD-00	-	Endkappen	grau	ABS
PA-ZAWGLAXDR-00	1,5	Aufhänger	Chrom	Stahl
PA-SPRGLAXM-00	-	Montagehalterung	silberfarben	ABS

Abdeckungen



PA-OSMLGLAXSO-00

PA-OSMLGLAX-00

PA-OSTRGLAX-00

Montagehalterung



PA-SPRGLAXM-00

Aufhänger



PA-ZAWGLAXDR-00



**Profil GLAX z radiatorem**





# Schrankunterbodenprofil GLAX zum Aufschieben auf die Platte mit Stärke 16 mm und 19 mm

Jetzt verfügbar

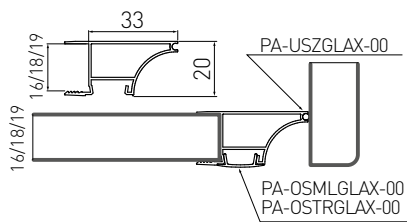

MAX  
28 W/m



		 BOARD mm	 L m			
PA-GLAXWN16-AL		16	2	Profil	silberfarben	Aluminium
PA-GLAXWN19-AL		19				
PA-OSMLGLAX-00		-	2	Abdeckung	milchig	Kunststoff
PA-OSTRGLAX-00					transparent	
PA-USZGLAX-00N		-	10	Dichtung	schwarz	EPDM

Abdeckungen



PA-OSMLGLAX-00



PA-OSTRGLAX-00

Dichtung



PA-USZGLAX-00N

ø2,5







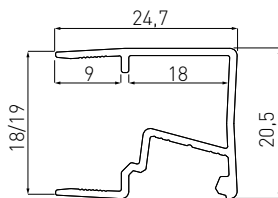

# Winkelprofil GLAX, zum Aufschieben auf die Platte mit Stärke 19 mm, einseitig, schmal

Jetzt verfügbar



MAX  
30 W/m



		 BOARD mm	 L m			
PA-GLAXMNB JW3M19-AL		19	3	Profil	silberfarben	Aluminium
PA-OSMLGLAXM3M-00		-		Abdeckung mini	milchig	Kunststoff
PA-OSTRGLAXM3M-00		-			transparent	

## Abdeckungen



PA-OSMLGLAXM3M-00



PA-OSTRGLAMX3M-00





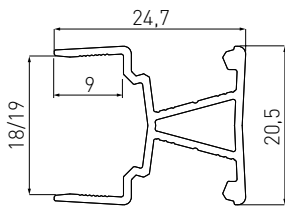

# Winkelprofil GLAX, zum Aufschieben auf die Platte mit Stärke 19 mm, zweiseitig, schmal

Jetzt verfügbar



MAX  
30 W/m



						
PA-GLAXMNBW3M19-AL	19	3	Profil	silberfarben	Aluminium	
PA-OSMLGLAXM3M-00	-		Abdeckung mini	milchig	Kunststoff	
PA-OSTRGLAXM3M-00	-			transparent		

## Abdeckungen



PA-OSMLGLAXM3M-00



PA-OSTRGLAMX3M-00

# Abdeckung EVO

Jetzt verfügbar



	 L mm		
A-MEVO-170-20M	1700	schwarz	Aluminium
A-MEVO-235-20M	2350		
A-MEVO-300-20M	3000		

# Abdeckung PRO

Jetzt verfügbar

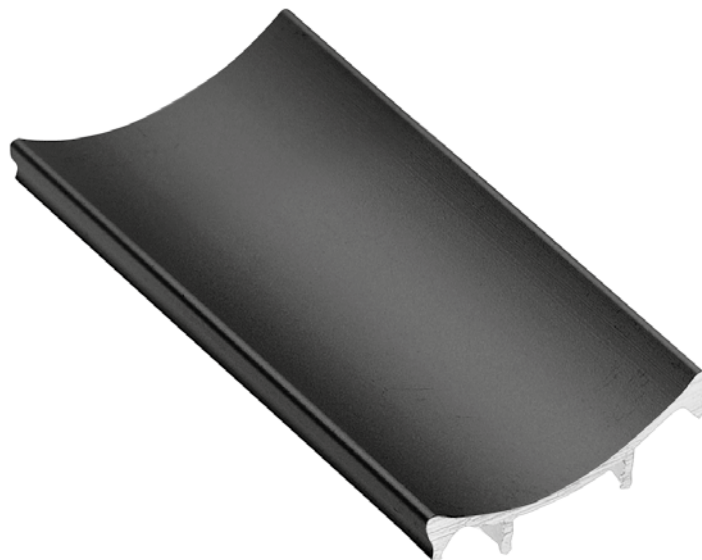

	 L mm		
A-MPRO-170-20M	1700	schwarz	Aluminium
A-MPRO-235-20M	2350		
A-MPRO-300-20M	3000		
A-MPRO-405-20M	4050		

# Untere Laufschiene EVO

Jetzt verfügbar



	 L mm		
A-TDEVO-170-20M	1700	schwarz	Aluminium
A-TDEVO-235-20M	2350		
A-TDEVO-405-20M	4050		
A-TDEVO-600-20M	6000		

# Untere Laufschiene PRO

Jetzt verfügbar

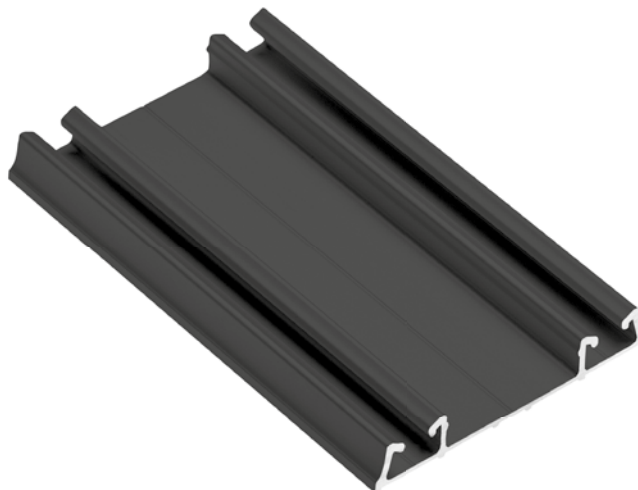

	 L mm		
A-TDPRO-170-20M	1700	schwarz	Aluminium
A-TDPRO-235-20M	2350		
A-TDPRO-300-20M	3000		
A-TDPRO-405-20M	4050		

# Abdeckung PRO

Jetzt verfügbar



	 L mm		
A-MPRO-170-10	1700	weiß	Aluminium
A-MPRO-235-10	2350		
A-MPRO-405-10	4050		

# Untere Laufschiene PRO

Jetzt verfügbar



	 L mm		
A-TDPRO-170-10	1700	weiß	Aluminium
A-TDPRO-235-10	2350		
A-TDPRO-405-10	4050		
A-TDPRO-600-10	6000		

# Griffprofil GEO 18

Jetzt verfügbar

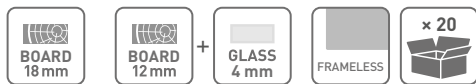
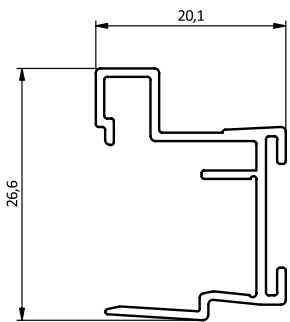

A-R18GE02-270-05	2700	Aluminium	Aluminium

# Griffprofil MOVENA

Jetzt verfügbar

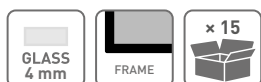
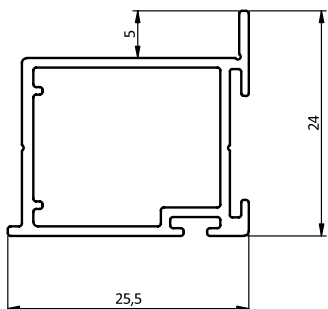

A-R4MOV-270-05	2700	Aluminium	Aluminium

# Untere Leiste 4 mm

Jetzt verfügbar

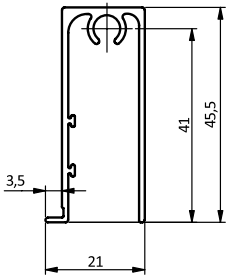

A-LD4MOV-300-05	3000	Aluminium	Aluminium

# Obere Leiste 4 mm

Jetzt verfügbar

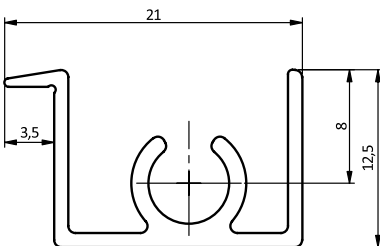

A-LG4MOV-300-05	3000	Aluminium	Aluminium

# GTV

ul. Przejazdowa 21  
05-800 Pruszków  
Poland



+ 48 22 44 47 272



+ 48 22 44 47 366



+ 48 22 44 47 324



+ 48 22 44 47 391



+ 48 22 44 47 569



+ 420 591 160 091



ООО 140073, РФ, «ГТВ РУС»  
Московская область,  
г. Люберецы, пос.Томилино  
мкрн. Птицефабрика, Литер 7А  
+ 7 495 640 15 88



GTV Croatia d.o.o  
Kovinska 4a, 10000 Zagreb  
Hrvatska  
+ 385 1 798 8089



GTV Czech Distribution s.r.o.  
CTPark Ostrava, Na Rovince 879  
720 00 Ostrava Hrabová  
Česká republika  
+420 591 160 091



GTV España Herrajes e Iluminación, S.L.  
Avenida Aragón 30 8  
46021 Valencia  
Spain  
+34 960 468 666

fax: +48 22 444 75 01  
e-mail: [info@gtv.com.pl](mailto:info@gtv.com.pl)  
[www.gtv.com.pl](http://www.gtv.com.pl)

Follow us on:

